

GLOUCESTER COUNTY SURVEY MARK DATA SHEET

STATION NO.
016

HORIZONTAL DATA : VA. STATE PLANE COORD. - SOUTH ZONE (NAD 1983)		
UNITS	EASTING (X)	NORTHING (Y)
METERS	3668116.703	1132563.089
U.S. SURVEY FT.	12034479.550	3715750.734
LATITUDE (DMS)		37 30 45.36203
LONGITUDE (DMS)		76 35 53.62299
SCALE FACTOR		0.99994860
CONVERGENCE \sphericalangle (DMS)		1 9 15.24
VERTICAL DATA : REF. TO NATL. GEOD. VERT. DATUM (1988)		
UNITS	STATION ELEVATION	
METERS	38.06	
U.S. SURVEY FT.	124.87	

STATION DESCRIPTION :

DISTRICT : PETSWORTH

A 3-1/4" ALUMINUM DISK MONUMENT SET APPROXIMATELY FLUSH WITH THE GROUND STAMPED STATION NO. 016. TO REACH: FROM THE INTERSECTION OF STATE ROUTE 601 AND STATE ROUTE 610 AT PAMPA, GO ABOUT 0.9 MILE SOUTH ON STATE ROUTE 610 TO INTERSECTION WITH DIRT LANE; GO ABOUT 0.2 MILE WEST ON DIRT LANE TO MONUMENT SITE ON NORTHWEST SIDE OF ROAD.

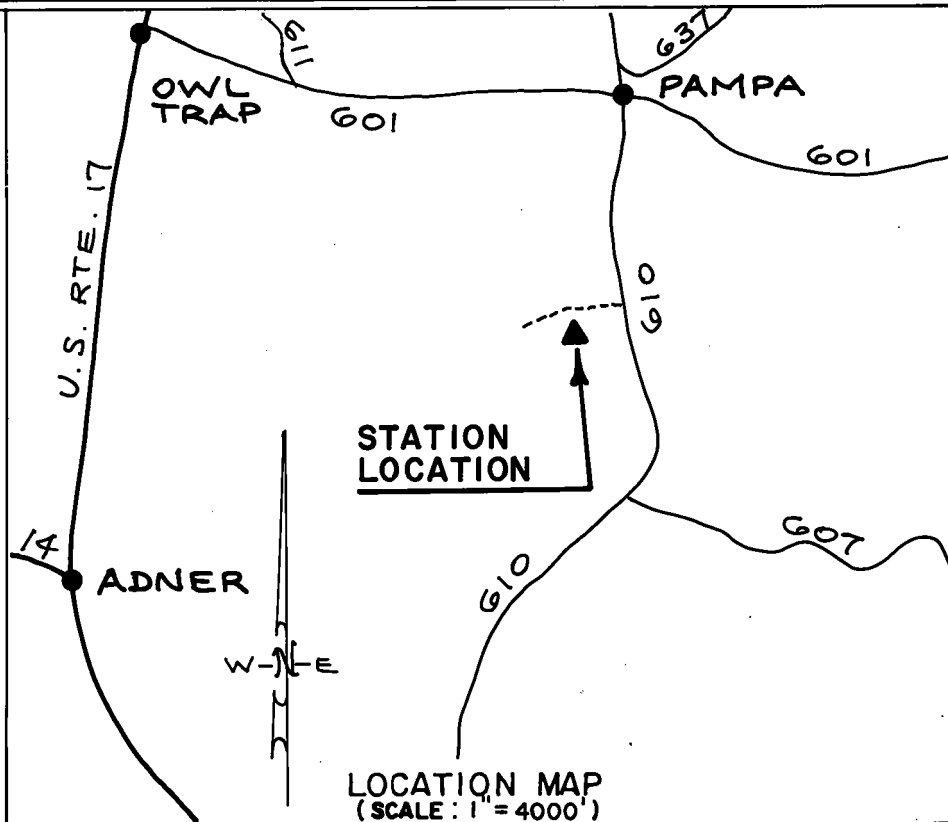
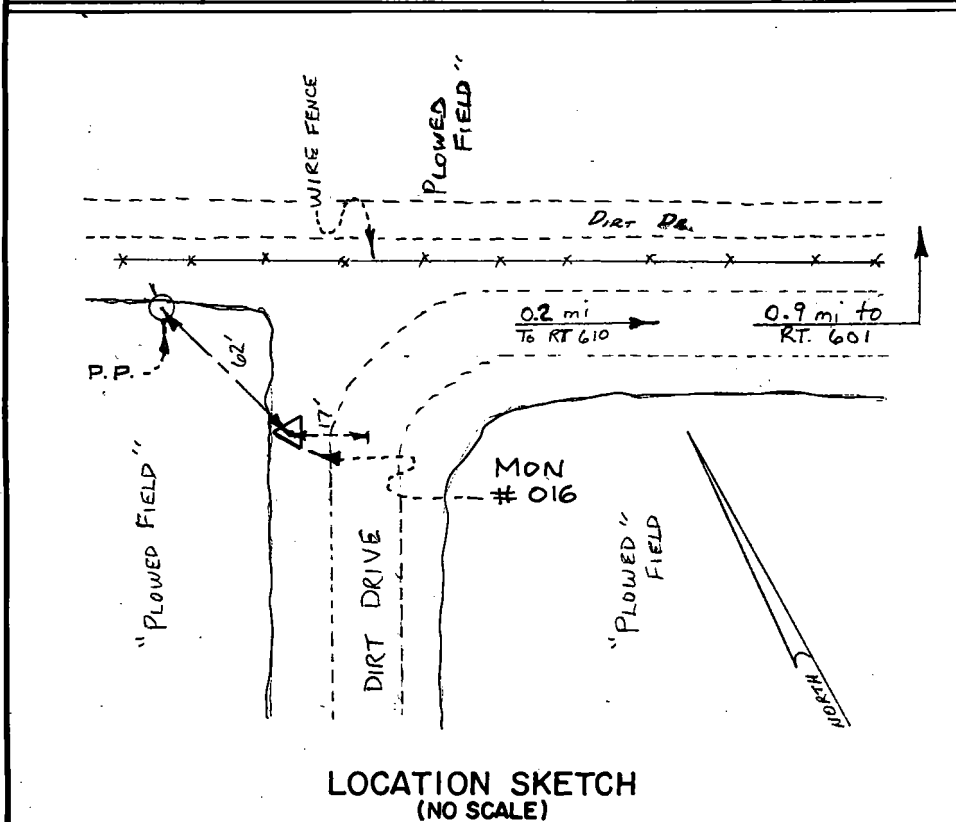

DATE: JANUARY, 1992

NOTE: USERS OF MONUMENTS LOCATED ON PRIVATE PROPERTY
MUST OBTAIN LAND OWNERS PERMISSION BEFORE ENTERING



DAWSON & PHILLIPS, P.C.
CERTIFIED LAND SURVEYORS
(804) 693-2993