

GLOUCESTER COUNTY SURVEY MARK DATA SHEET

STATION NO.

046

HORIZONTAL DATA :

VA. STATE PLANE COORD. - SOUTH ZONE (NAD 1983)

UNITS	EASTING (X)	NORTHING (Y)
METERS	3675040.866	1136249.943
U.S. SURVEY FT.	12057196.575	3727846.688
LATITUDE (DMS)	37 32 40.31128	
LONGITUDE (DMS)	76 31 8.57468	
SCALE FACTOR	0.99995016	
CONVERGENCE \sphericalangle (DMS)	1 12 8.24	

STATION DESCRIPTION :

DISTRICT :

PETSWORTH

A 3 1/4" ALUMINUM DISK MONUMENT SET APPROXIMATELY FLUSH WITH THE GROUND STAMPED STATION NO. 046. TO REACH: FROM THE INTERSECTION OF STATE ROUTE 198 AND STATE ROUTE 602 AT DUTTON, GO ABOUT 4.15 MILES NORTHWEST ON STATE ROUTE 198 TO A DIRT AND GRAVEL DRIVE ON RIGHT AT 36" OAK TREE. CONTINUE NORTH ON DIRT AND GRAVEL ROAD ABOUT 0.8 MILE TO MONUMENT SITE.

VERTICAL DATA :

REF. TO NATL. GEOD. VERT. DATUM (1988)

UNITS	STATION ELEVATION
METERS	3.89
U.S. SURVEY FT.	12.77

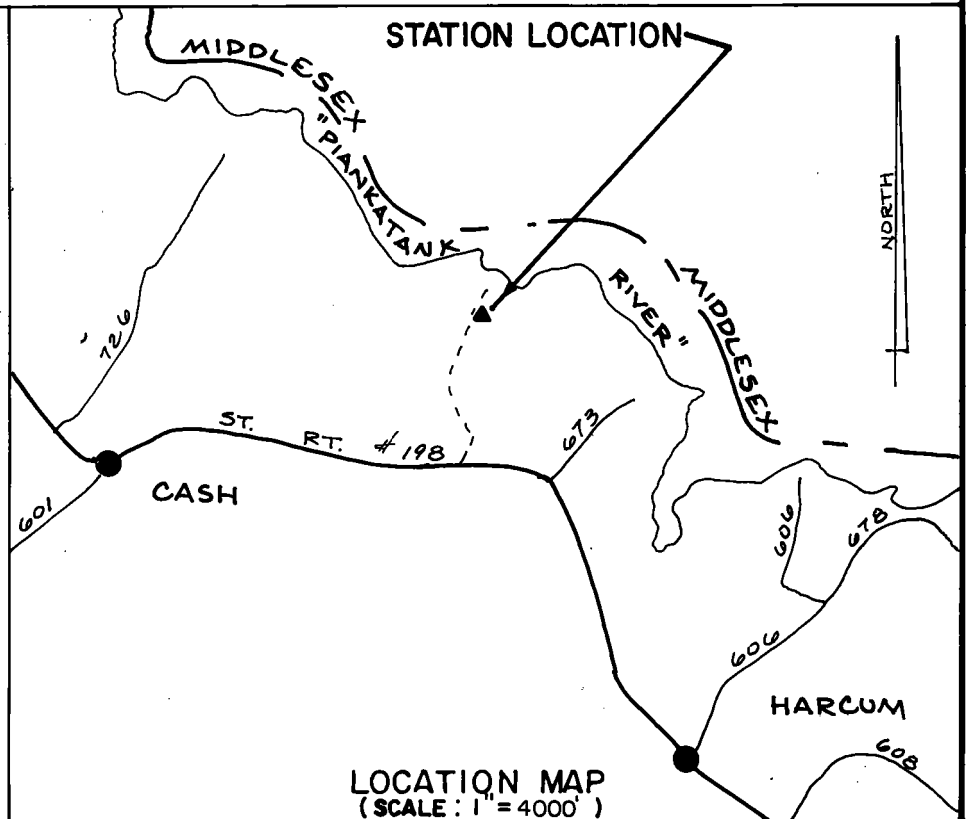
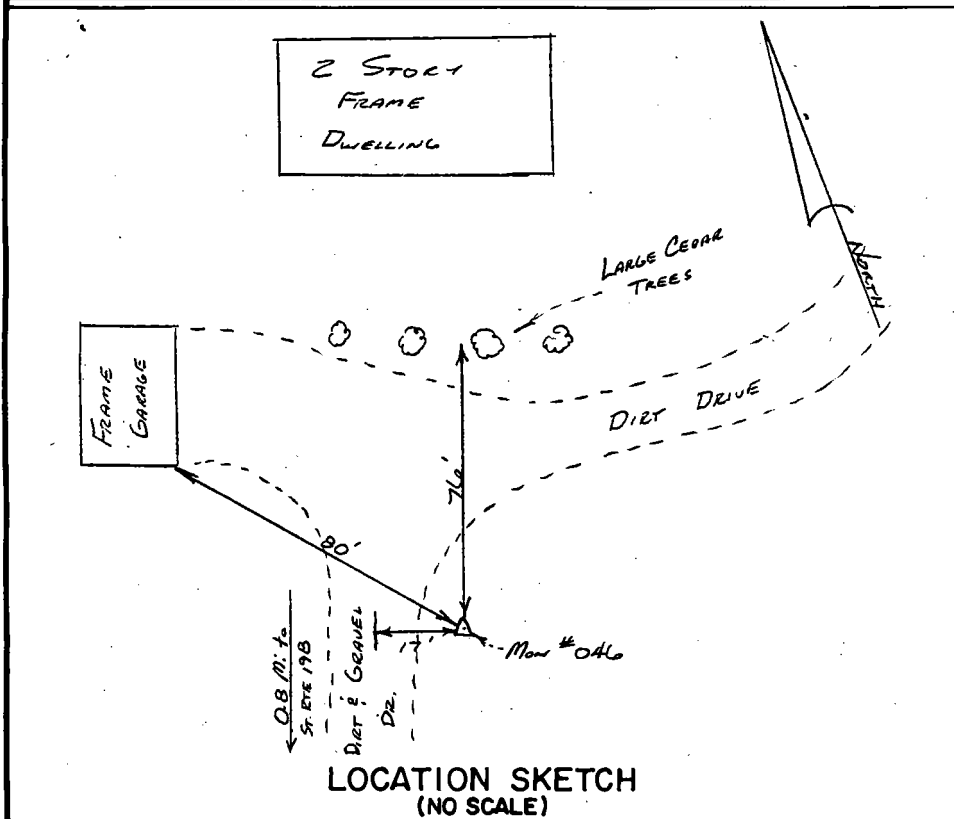

DATE: JANUARY, 1992

NOTE: USERS OF MONUMENTS LOCATED ON PRIVATE PROPERTY MUST OBTAIN LAND OWNERS PERMISSION BEFORE ENTERING



DAWSON & PHILLIPS, P.C.

CERTIFIED LAND SURVEYORS
(804) 693-2993