

# GLOUCESTER COUNTY SURVEY MARK DATA SHEET

**STATION NO.**  
119

**HORIZONTAL DATA :**

VA. STATE PLANE COORD. - SOUTH ZONE (NAD 1983)

UNITS	EASTING (X)	NORTHING (Y)
METERS	3677868.617	1117828.424
U.S. SURVEY FT.	12066473.954	3667395.631
LATITUDE (DMS)	37 22 40.81693	
LONGITUDE (DMS)	76 29 29.37141	
SCALE FACTOR	0.9999452	
CONVERGENCE $\kappa$ (DMS)	1 13 8.45	

**STATION DESCRIPTION :**

**DISTRICT :** WARE

A 3-1/4" ALUMINUM DISK MONUMENT SET APPROXIMATELY FLUSH WITH THE GROUND STAMPED STATION NO. 119. TO REACH: FROM THE INTERSECTION OF U. S. ROUTE 17 AND STATE ROUTE 615 AT SHORT LANE, GO ABOUT 1.3 MILES EAST ON STATE ROUTE 615 TO INTERSECTION WITH STATE ROUTE 629; GO ABOUT 0.8 MILE NORTH ON STATE ROUTE 629 TO INTERSECTION WITH STATE ROUTE 626; GO ABOUT 0.9 MILE EAST ON STATE ROUTE 626 TO INTERSECTION WITH STATE ROUTE 628; GO ABOUT 0.8 MILE SOUTH ON STATE ROUTE 628 TO INTERSECTION WITH STATE ROUTE 627 (GRAVEL ROAD); GO APPROXIMATELY 128' SOUTH ON STATE ROUTE 627 TO MONUMENT SITE.

**VERTICAL DATA :**

REF. TO NATL. GEOD. VERT. DATUM (1988)

UNITS	STATION ELEVATION
METERS	2.78
U.S. SURVEY FT.	9.12

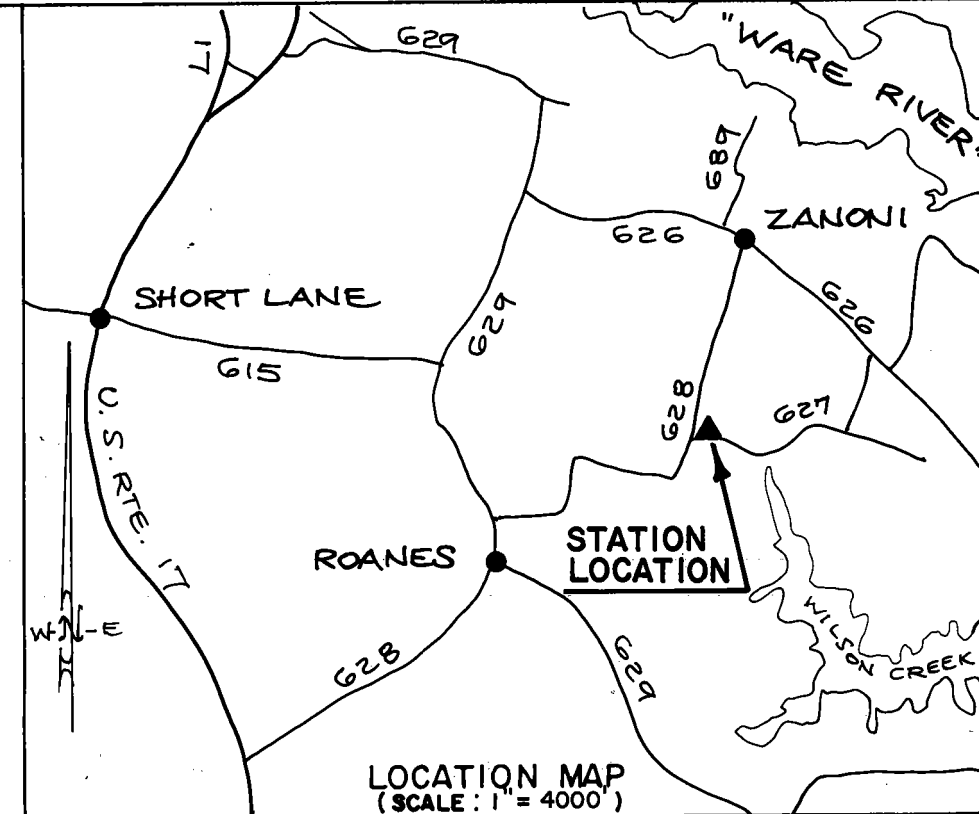
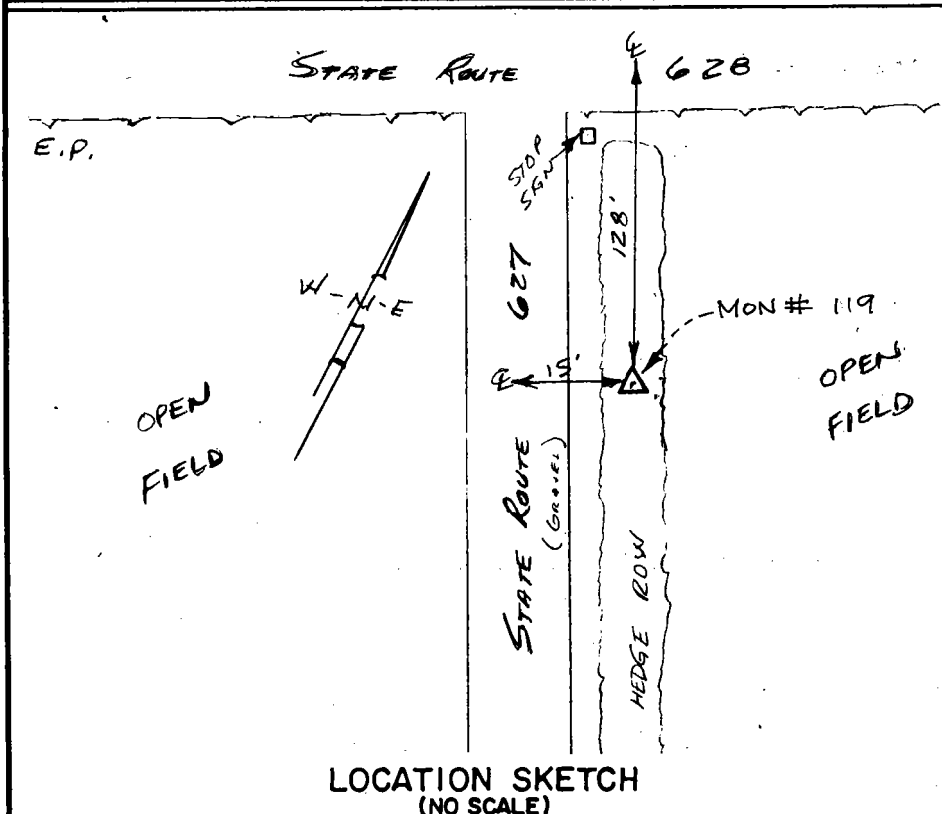

DATE: JANUARY, 1992

NOTE: USERS OF MONUMENTS LOCATED ON PRIVATE PROPERTY  
MUST OBTAIN LAND OWNERS PERMISSION BEFORE ENTERING



**DAWSON & PHILLIPS, P.C.**  
CERTIFIED LAND SURVEYORS  
(604) 693-2993